

ASSEMBLY INSTRUCTION

ITEM NO : SH1152

5PCS PACK DINING SET - TABLE

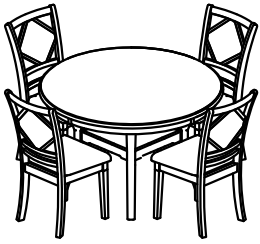

Thank you for purchasing this product. Please take time to read and follow the instructions below. Check that you have all parts and hardware before assemble. Parts apparently missing are often found in the paking materials. If you do not have all the parts listed, have your dealer contact us and they will be sent to you immediately.



It is recommended to install protective pads under all legs and supports to avoid damage or scratches when placing furniture on a wood floor or other hard surcafe, and to limit indentation and prevent discoloration if placing on carpet.



Hardware may loose over time. Periodically check to make sure all connection are tight. Re-tighten if necessary.

PARTS LIST			
NO.	SKETCH	DECRPTION	Q'TY
A		Table Top	1 pc
B		Table Shelves	1 pc
C		Table Legs	4 pcs
D		Table Leg Base Panel	4 pcs

HARDWARE LIST				
NO.	SKETCH	DECRPTION	SIZE	Q'TY
1		Flat Washers	5/16" x 1/2" x 0.08"	20 pcs
2		Lock Washers	5/16" x 3/4" x 0.08"	20 pcs
3		Bolts	5/16" x 65mm	8 pcs
4		Bolts	5/16" x 35mm	4 pcs
5		Bolts	1/4" x 30mm	8 pcs
6		Allen key	4mm	1 pc

* ABOVE HARDWARE ARE PACKED IN #SH1152 FOR ASSEMBLY.

STEP 1

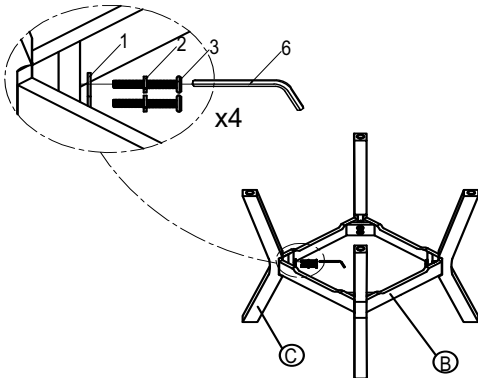

STEP 2

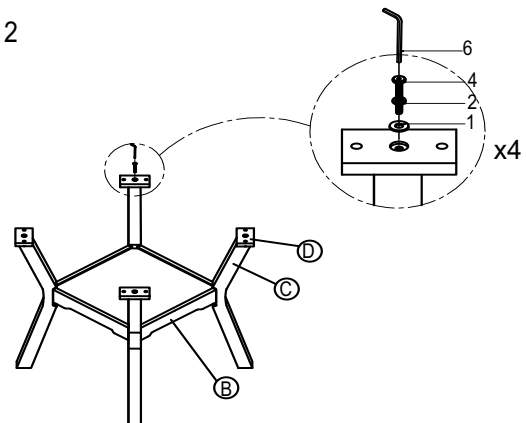

STEP 3

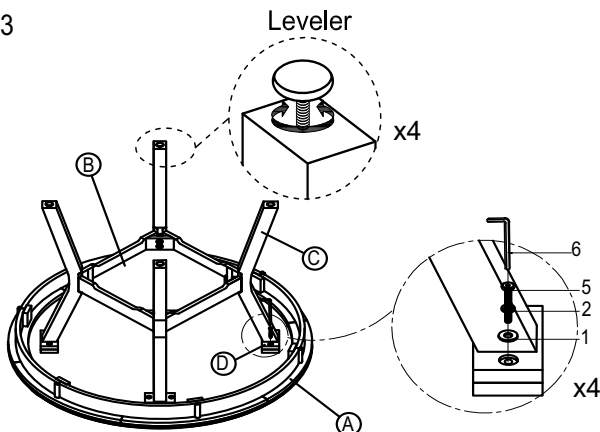

ASSEMBLY COMPLETED

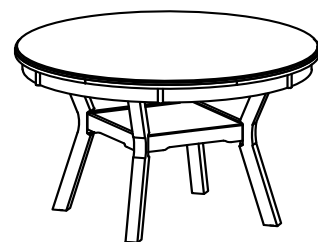

ASSEMBLY INSTRUCTION

ITEM NO : SH1152

5PCS PACK DINING SET - CHAIR

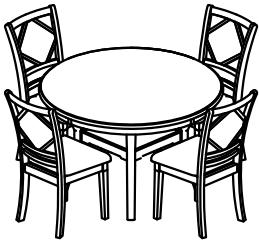

Thank you for purchasing this product. Please take time to read and follow the instructions below. Check that you have all parts and hardware before assemble. Parts apparently missing are often found in the paking materials. If you do not have all the parts listed, have your dealer contact us and they will be sent to you immediately.



It is recommended to install protective pads under all legs and supports to avoid damage or scratches when placing furniture on a wood floor or other hard surcafe, and to limit indentation and prevent discoloration if placing on carpet.



Hardware may loose over time. Periodically check to make sure all connection are tight. Re-tighten if necessary.

PART LIST

NO	SKETCH	DESCRIPTION	Q'TY
A		Cushion Seat	4 pcs
B		Seat Frame	4 pcs
C		Chair Back	4 pcs
D		Front legs	8 pcs

HARDWARE LIST

NO	SKETCH	DESCRIPTION	SIZE	Q'TY
1		Flat Washers	5/16" x 3/4" x 0.08"	44 pcs
2		Lock Washers	5/16" x 1/2" x 0.08"	44 pcs
3		Bolts	1/4" x 45mm	12 pcs
4		Bolts	1/4" x 75mm	16 pcs
5		Nuts	5/16"	16 pcs
6		Allen Wrench	5/16"	1 pc
7		Wood Screws	#4 x 15mm	16 pcs

* ABOVE HARDWARE ARE PACKED IN #SH1152 FOR ASSEMBLY.

* SCREW DRIVER (NOT PROVIDED).

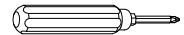

STEP 1

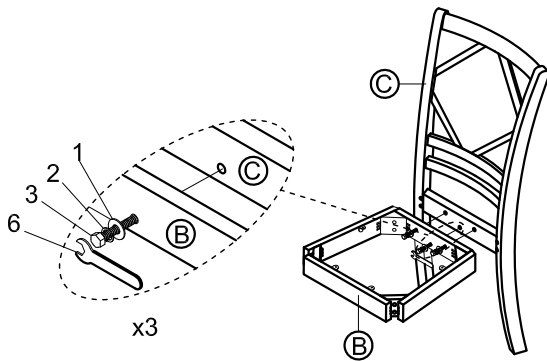

STEP 2

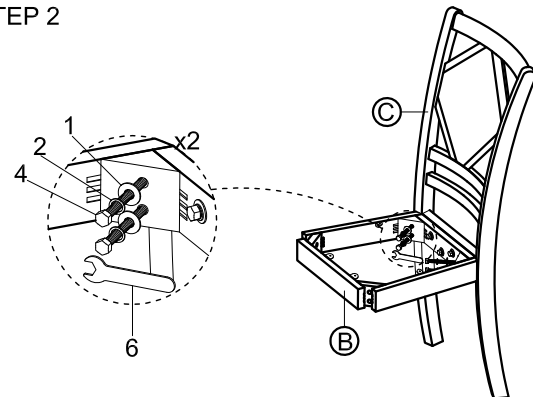

STEP 3

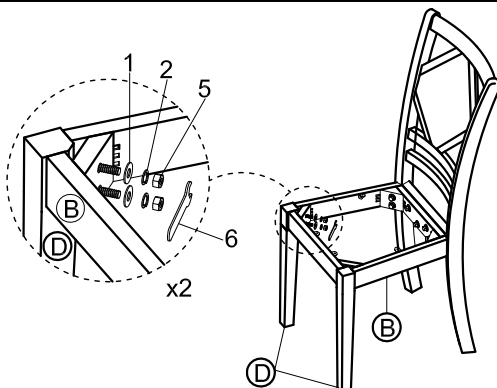

ASSEMBLY COMPLETED

