

ASSEMBLY INSTRUCTION

SH460BGE & SH460BLU & SH460GRY & SH460DGR & SH460PNK

1 Back Rest

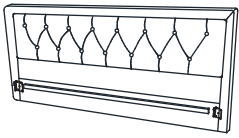

x1

2 Arm

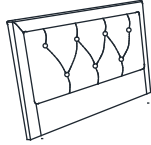

x1

3 Side Rail (L)

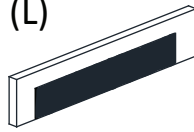

x2

4 Side Rail (R)

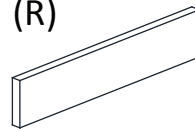

x2

5 Front Side Rail

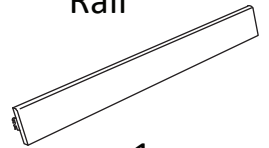

x1

6 Legs



x4

7 Slats

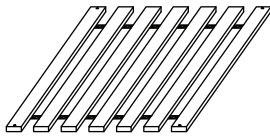

x2

A Bolts

M8 x 20mm

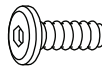

x8

B Bolts

M6 x 35mm

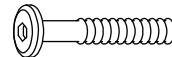

x8

C Bolts

M6 x 70mm

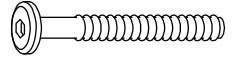

x4

D Lock Washers



x8

E Flat Washers

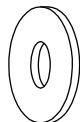

x8

F Screws

M4 x 32mm

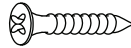

x12

G Wood Dowel

M8 x 30mm



x4

H Allen Key

M4 x 100mm



x1

I Allen Key

M5 x 65mm



x1

J L Bracket

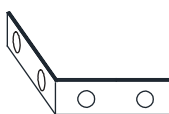

x1

K Metal Plate



x2

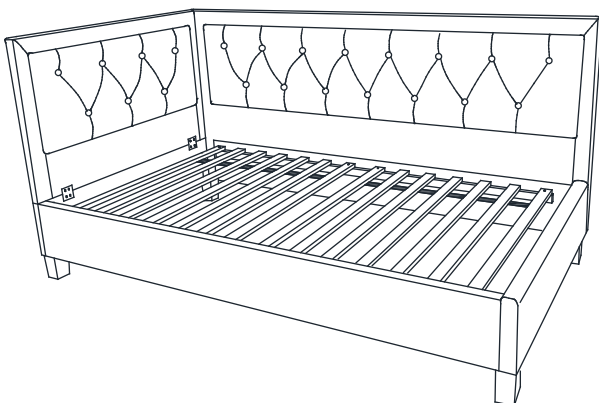

or

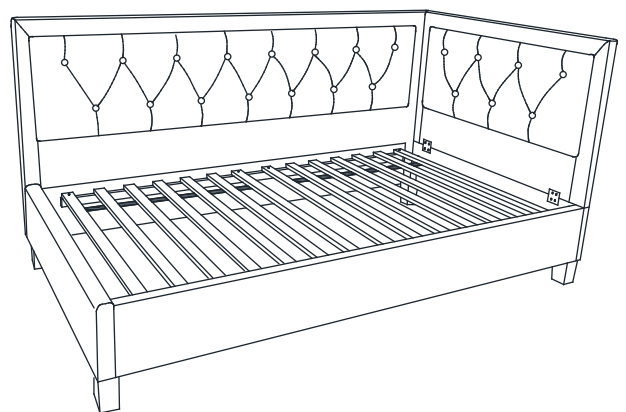

This page lists all the contents included in the box. Please take the time to identify the hardware as well as the individual components to this product. As you unpack and prepare for assembly, place the contents on a carpeted or padded area to protect them from damage.

ASSEMBLY INSTRUCTION

SH460BGE & SH460BLU & SH460GRY & SH460DGR & SH460PNK

- 1** Insert each Wood Dowel (G) to the Legs (6) then attach to the bottom of Back Rest (1) and Side Rail (3) & (4) by using Allen Bolt (C). Tighten bolts using Allen Wrench (H) provided.

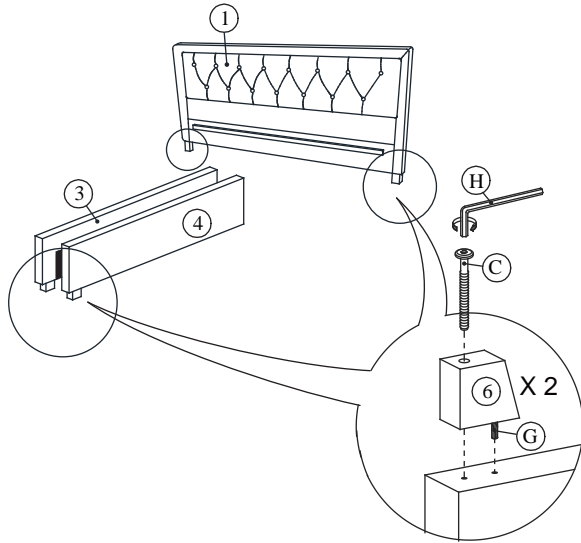

- 2** Attach the Front Rail (5) and Back Rest (1) to the Side Rail (3) & (4) aligning holes and securing with 2 Allen Bolts (A) per each end. (DO NOT FULLY TIGHTEN BOLTS FOR THIS STEP)

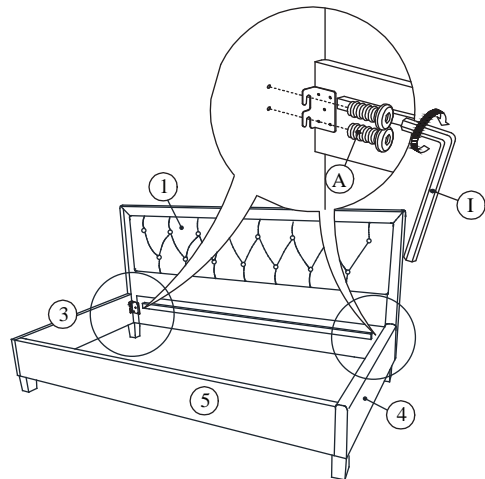

- 3** follow marking line

STEP 3.1 Place the Arm (2) on the Side Rail (3) or (4) depend your preference. Aligning holes and securing with 4 Allen Bolts (B), 4 Spring Washer (D) and 4 Flat Washer (E).

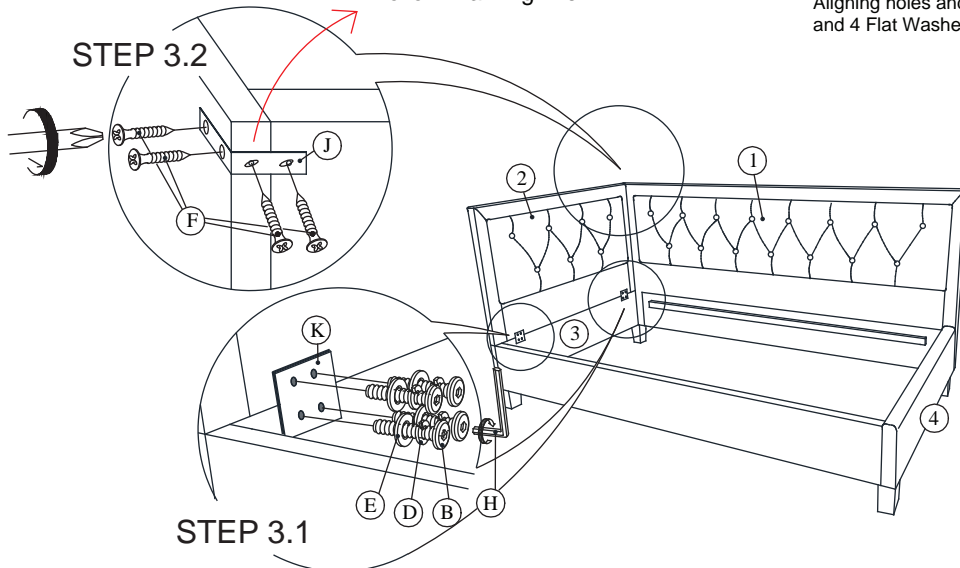

or

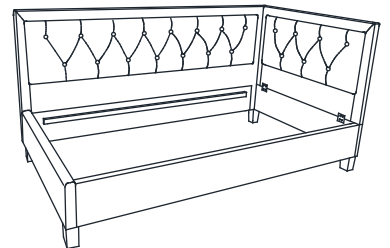

- 4** Tighten all bolts from STEP 2 using the Allen Wrench (J) that has been provided. Attach Slat (7) to Front Rail (5) and Back Rest (1) by using 4 Screw (F). Tighten all screws using phillips head screwdriver (not included).

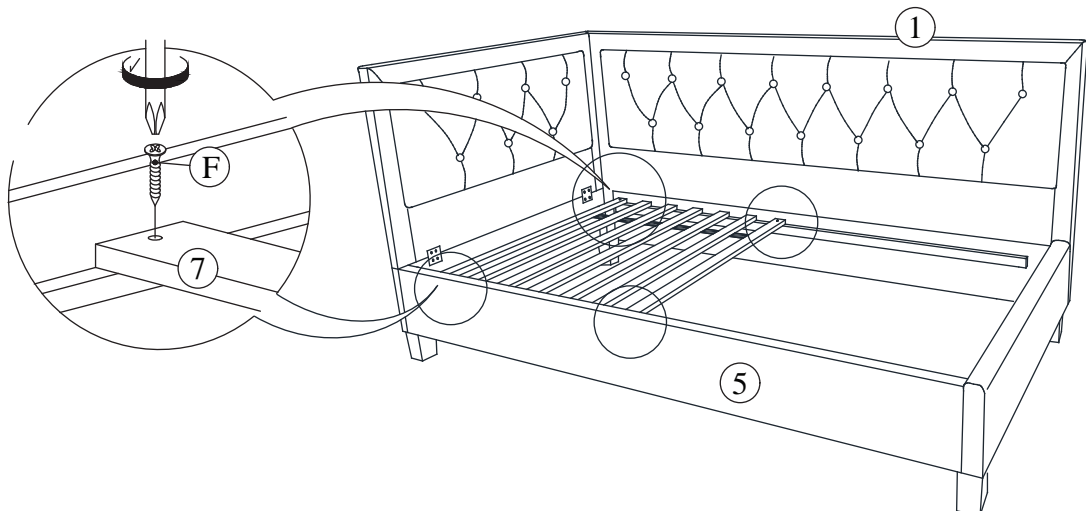

Cleaning & Care

Treat surface with care. Surface is resistant to scratches but is not scratch resistant. Clean surfaces with a dry or damp soft cloth. Do not use abrasive cleaners. Hardware may loosen over time. Periodically check that all connections are tight.