

ASSEMBLY INSTRUCTION

ITEM NO: SH2859-1/2/3 QUEEN BED

SH2859-1 QUEEN SLEIGH HEADBOARD

SH2859-2 QUEEN PANEL FOOTBOARD, SLATS & SUPPORT LEGS

SH2859-3 QUEEN / KING SIDE RAILS

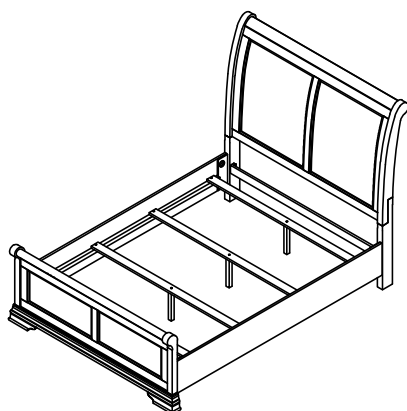

Thank you for purchasing this product. Please take time to read and follow instructions below. Check that you have all parts and hardware before assembly. Parts apparently missing are often found in packing materials. If you do not have all parts listed, have your dealer contact us and they will be sent to you immediately.

▲ It is recommended to install protective pads under all legs and supports to avoid damage or scratches when placing furniture on a wood floor or other hard surface, and to limit indentation and prevent discoloration if placing on carpet.

▲ Hardware may loosen over time. Periodically check to make sure all connections are tight. Re-tighten if necessary.

▲ Foundation/ box spring required, sold separately.

SH2859-1 PART LIST			
NO	SKETCH	DESCRIPTION	Q'TY
A		QUEEN HEADBOARD	1 pc

SH2859-2 PARTS LIST			
NO	SKETCH	DESCRIPTION	Q'TY
B		QUEEN FOOTBOARD	1 pc
C		SLATS	4 pcs
D		SUPPORT LEGS	4 pcs

SH2859-3 PART LIST			
NO	SKETCH	DESCRIPTION	Q'TY
E		QUEEN/KING SIDE RAIL	2 pcs

HARDWARE LIST				
NO	SKETCH	DESCRIPTION	SIZE	Q'TY
1		WRENCH KEY	1/2" x 3 1/2"	1 pc
2		HEX NUT	Ø5/16" x 1/2 x 11/16	8 pcs
3		SPRING WASHER	5/16" x 1/2" x 11/32" x 1/12"	8 pcs
4		CURVE WASHER	Ø5/16" x 1 1/2 x 11/32 x 9/16 x 1/16	8 pcs
5		BOLT	Ø5/16x3 1/2	8 pcs
6		SCREW	M4 1 1/6"	8 pcs

** ABOVE HARDWARE ARE PACKED IN #SH2859-2 FOR ASSEMBLY

*SCREWDRIVER (NOT PROVIDED)

STEP 1

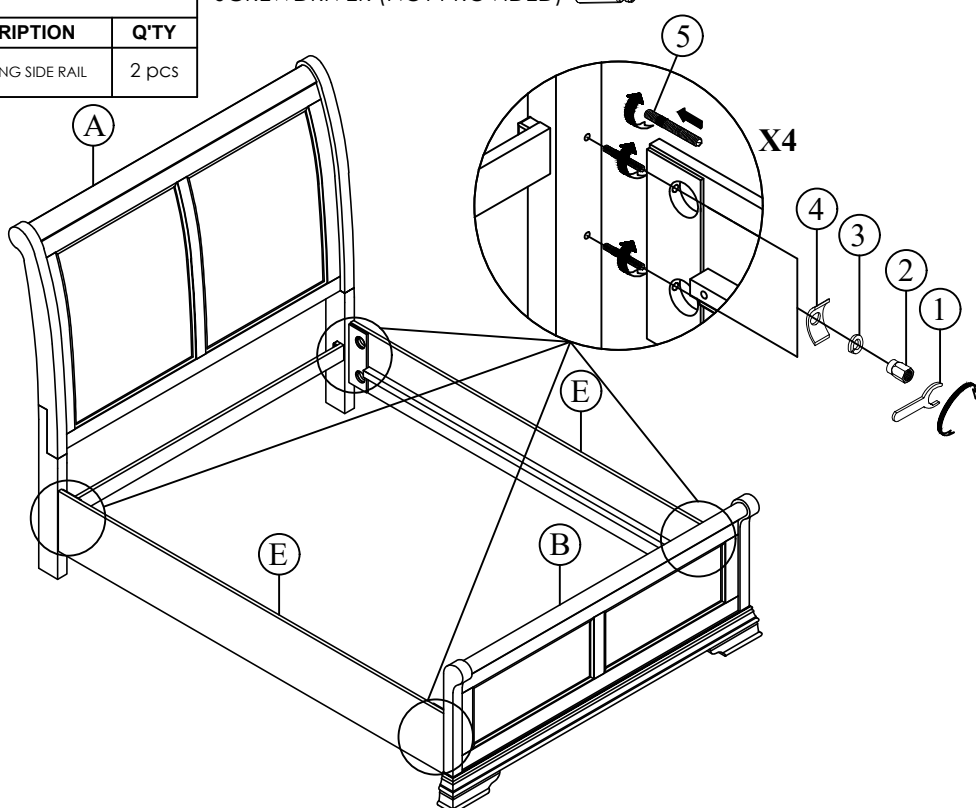

MADE IN VIETNAM

Page 1 of 2

DO NOT TIGHTEN BOLTS COMPLETELY ASSEMBLED.

ASSEMBLY INSTRUCTION

ITEM NO: SH2859-1/2/3 QUEEN BED

SH2859-1 QUEEN SLEIGH HEADBOARD

SH2859-2 QUEEN PANEL FOOTBOARD, SLATS & SUPPORT LEGS

SH2859-3 QUEEN / KING SIDE RAILS

STEP 2

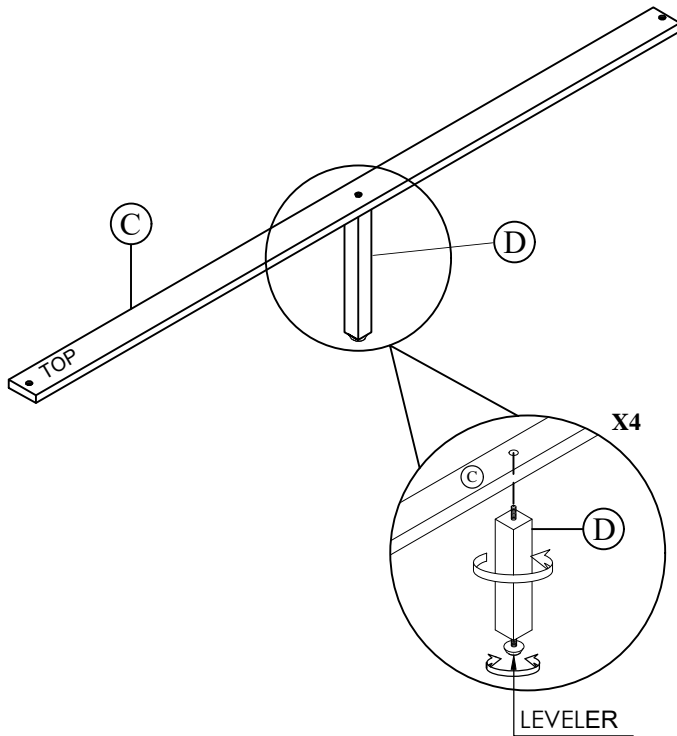

STEP 3

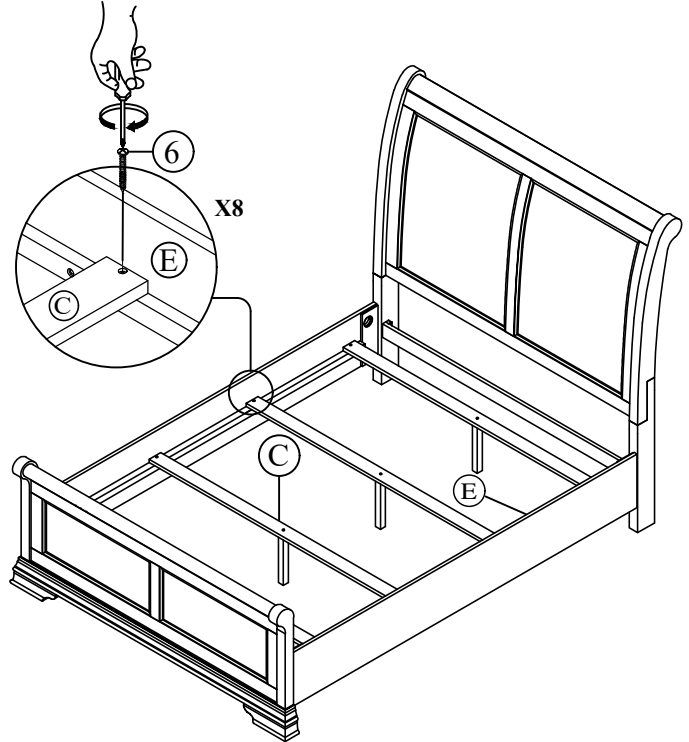

Completed

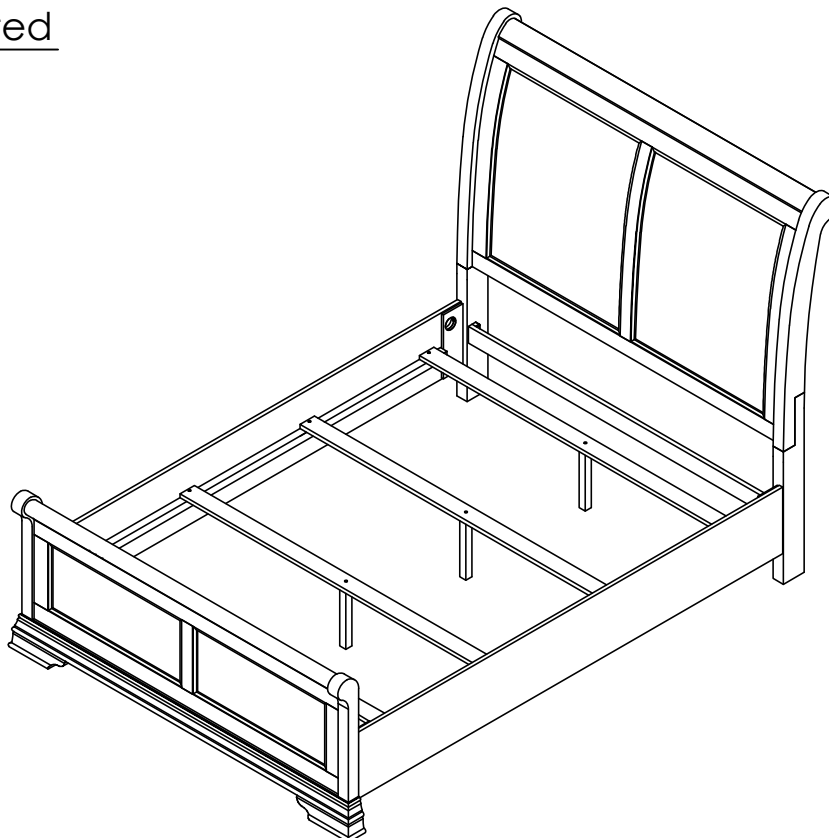

MADE IN VIETNAM

Page 2 of 2

DO NOT TIGHTEN BOLTS COMPLETELY ASSEMBLED.