

ASSEMBLY INSTRUCTION

ITEM NO: SH2859-5 DRESSER SH2859-6 MIRROR

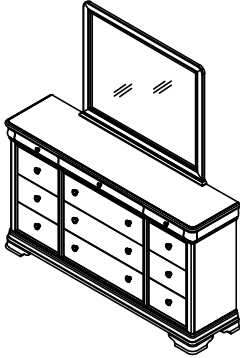

Thank you for purchasing this product. Please take time to read and follow instructions below. Check that you have all parts and hardware before assembly. Parts apparently missing are often found in packing materials. If you do not have all parts listed, have your dealer contact us and they will be sent to you immediately.

▲ It is recommended to install protective pads under all legs and supports to avoid damage or scratches when placing furniture on a wood floor or other hard surface, and to limit indentation and prevent discoloration if placing on carpet.

▲ Hardware may loosen over time. Periodically check to make sure all connections are tight. Re-tighten if necessary.

NOTE

Tipping restraint hardware kit is included with this product. Refer to installation instruction in the hardware pack.

*ANTI-TIPPING HARDWARE PACK IS AT THE BACK PANEL.

SH2859-5 PART LIST			
NO	SKETCH	DESCRIPTION	Q'TY
A		DRESSER	1 pc

SH2859-5 HARDWARE LIST			
NO	SKETCH	DESCRIPTION	Q'TY
1		TIPPING RESTRAINT	1 set

SH2859-6 PARTS LIST			
NO	SKETCH	DESCRIPTION	Q'TY
B		MIRROR	1 pc
C		MIRROR SUPPORTS	2 pcs

**ABOVE HARDWARE ARE PACKED IN #SH2859-5 FOR ASSEMBLY
*SCREWDRIVER (NOT PROVIDED)

SH2859-6 HARDWARE LIST				
NO	SKETCH	DESCRIPTION	SIZE	Q'TY
2		BOLT	Ø1/4"-20x1 1/2"	8 pcs
3		SPRING WASHER	Ø1/4" x 1/2" x 9/32" x 1/12"	8 pcs
4		FLAT WASHER	Ø1/4" x 3/4" x 9/32" x 5/64"	8 pcs
5		ALLEN KEY	5/32 x 2 1/4"	1 pc

**ABOVE HARDWARE ARE PACKED IN #SH2859-6 FOR ASSEMBLY

STEP 1

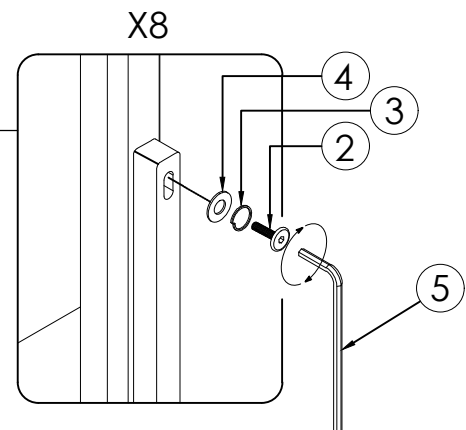
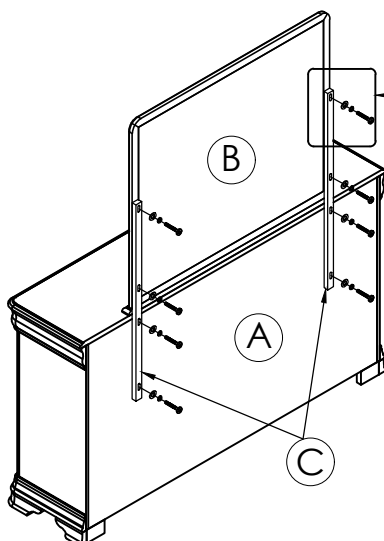

ASSEMBLY INSTRUCTION

ITEM NO: SH2859-5 DRESSER
SH2859-6 MIRROR

STEP 2

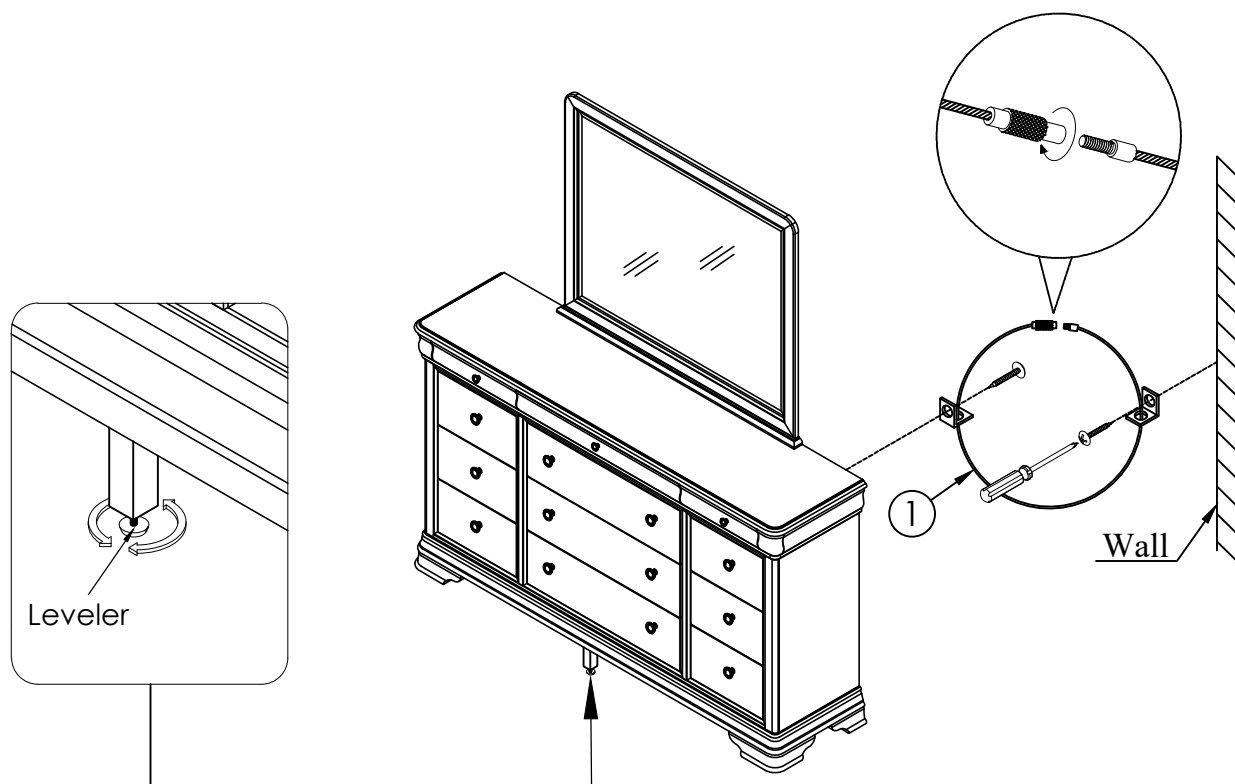

Completed

