



ASSEMBLY INSTRUCTION

ITEM # : 2056-1 QUEEN HB WITH LED STRIPPING
2056-2 QUEEN FB
2056-3 QUEEN RAILS

PART LIST		
1	HEADBOARD	1PC
2	HEADBOARD POST RSF	1PC
3	HEADBOARD POST LSF	1PC
4	FOOTBOARD	1PC
5	SUPPORT LEG OF SLAT	4PCS
6	SLAT	1ROLL/4PCS
7	RAIL	2PCS

HARDWARE LIST IN - 1			
A		BOLT (Ø 1/4" x 1-3/8")	6PCS
B		SPRING WASHER (Ø1/4")	6PCS
C		FLAT WASHER (Ø1/4")	6PCS
D		ALLEN KEY	1PC
E		SCREW 8# x 1"	8PCS

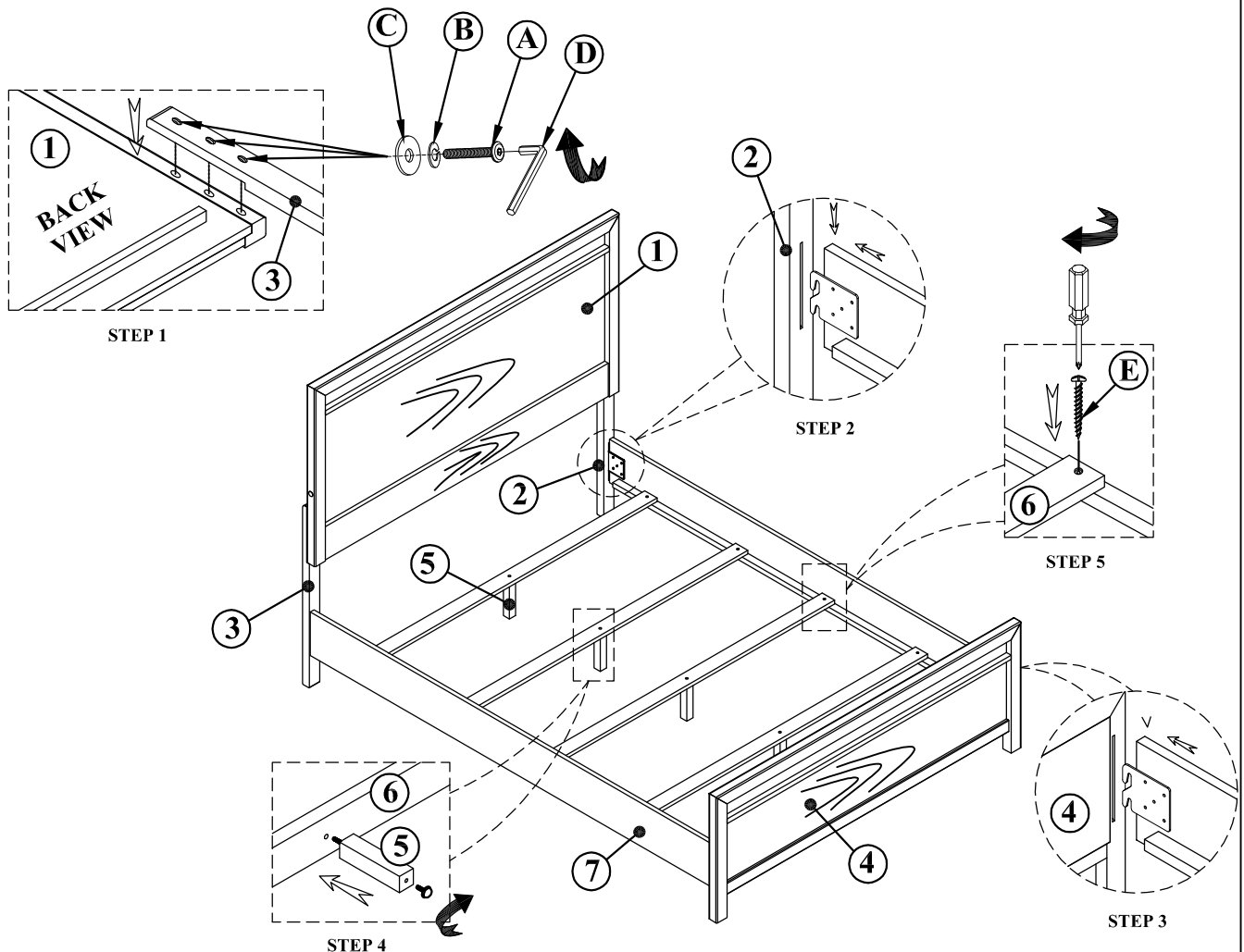

MADE IN VIETNAM



For items use on wooden floor, hard surfaces or carpets, it is recommended to install protective pads under all legs and supports to avoid/prevent from damages/scratches and discoloration.